

Optional Ground Attachment

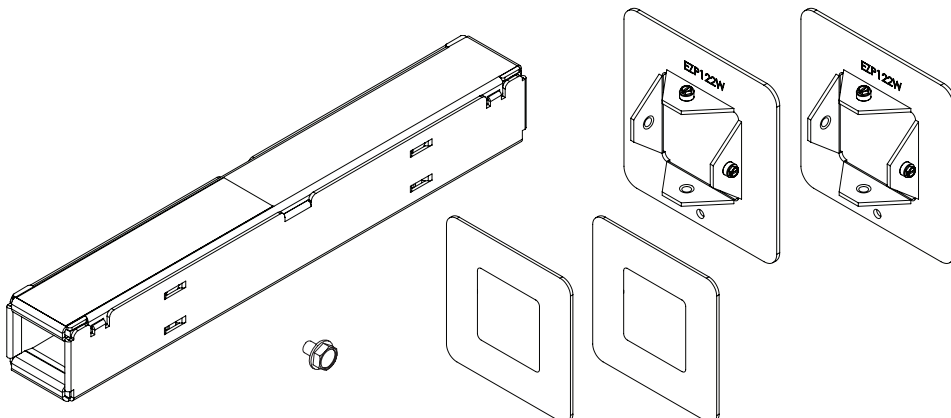

Parts Included (Not to Scale)

New Work Installations

1

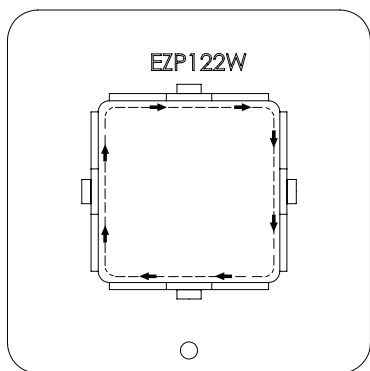

Cut nominal 2" (52 mm) diameter opening in wall. For rectangular openings, inside opening of wall plate may be used as a template.

2

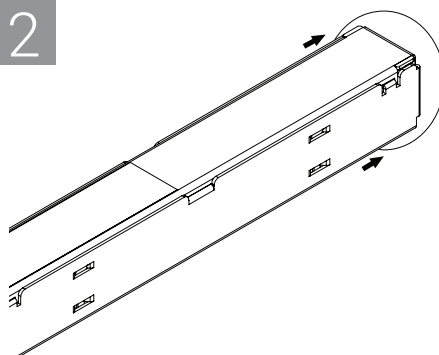

Slide pathway into opening with ends projecting equally from wall surfaces.

3

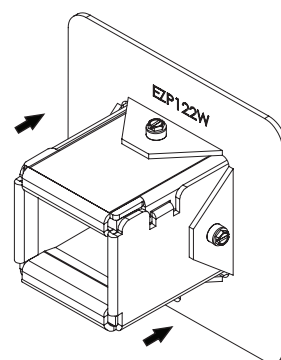

Slide plate and gasket around pathway on both sides of wall.

4

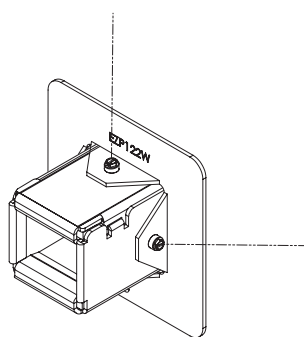

Fasten plate onto pathway using any standard slotted screwdriver, 1/4" open-end or closed-end wrench, or 1/4" nut driver.



Old Work Installations (Cables Already Installed)

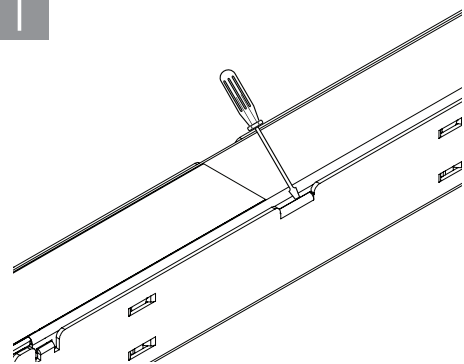

1
Open pathway by placing a screw driver in indent in middle of pathway, pivoting lid off of device body

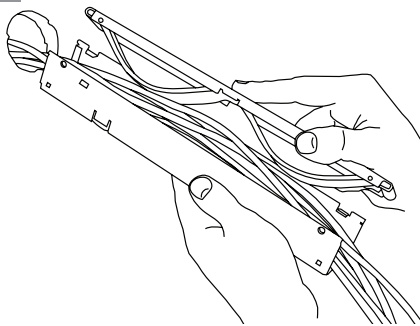

2
Place pathway around previously installed cables

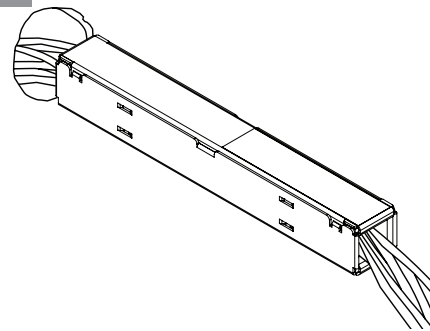

3
Close pathway around cables

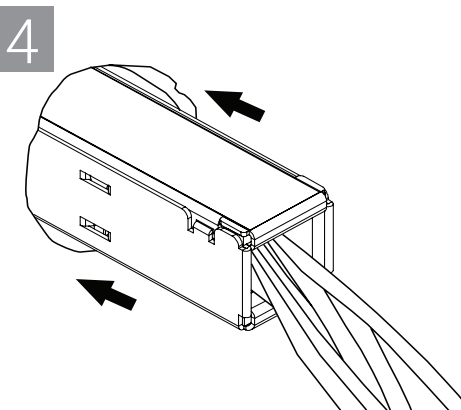

4
Place pathway into opening with ends projecting equally from wall surfaces

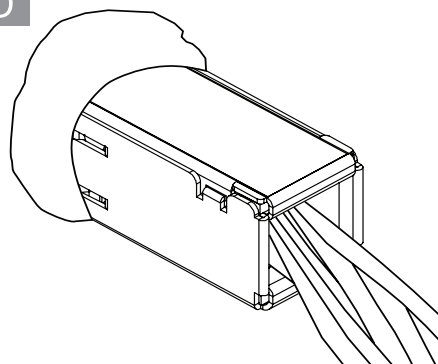

5
Fill annular space between device and wall with approved SpecSeal® Firestop Sealant. See UL System for more detail.

