

System No. FF-S-0038

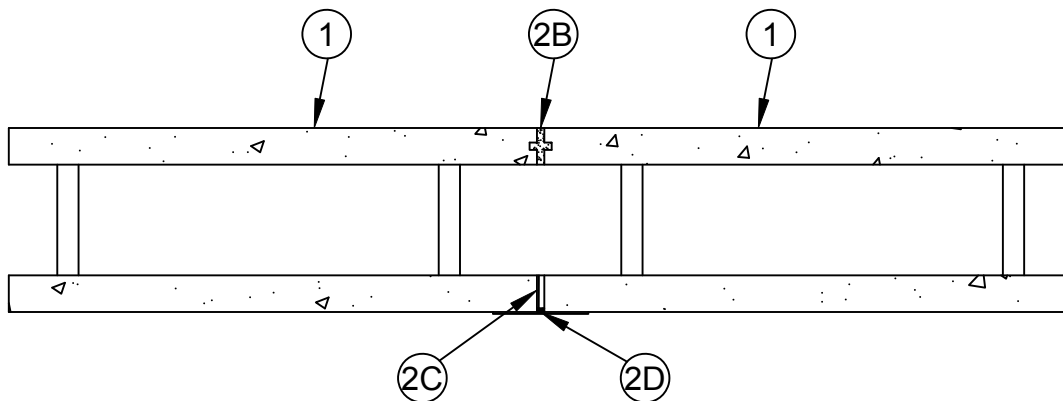

ANSI/UL2079	CAN/ULC S115
Assembly Rating - 2 Hr	F Rating - 2 Hr
Joint Width - 1/2 in. Max	FT Rating - 2 Hr
L Rating At Ambient - Less Than 1 CFM/lin ft	FH Rating - 2 Hr
L Rating At 400 F - Less Than 1 CFM/lin ft	FTH Rating - 2 Hr
	Joint Width - 12.7 mm Max
	L Rating At Ambient - Less Than 1.55 L/s/m
	L Rating At 400°F - Less Than 1.55 L/s/m



- 1. Precast Concrete Units (CFTV)*** - Precast, pre-stressed, dual deck units constructed in accordance with Floor-Ceiling Design No. K919.

FINFROCK INDUSTRIES INC - Type Dual Deck

- 2. Joint System** - The max width of joint system is 1/2 in. (12.7 mm). The joint system shall consist of the following:
 - A. Packing Material** - (Optional, Not Shown) - To facilitate installation of sealant (Item 2B1), open or closed cell polyethylene foam backer rod, mineral wool batt insulation or fiberglass batt insulation may be used as form to prevent leakage of fill material. If installed, packing material to be recessed from top surface of floor to accommodate required thickness of fill material.
 - B. Non-Shrink Grout** - Nom 2-1/2 in. (64 mm) non-shrink grout installed to completely fill the joint on the top slab.
 - B1. Fill, Void or Cavity Material* - Sealant** - (Optional, Not Shown) - As an alternate to the non-shrink grout (Item 2B) at top of floor, min 1-in. (25 mm) thickness of fill material applied within the joint, flush with the top surface of the floor.

SPECIFIED TECHNOLOGIES INC - SpecSeal SIL300 Sealant or SpecSeal SIL300SL

- C. Fill, Void or Cavity Materials*** - Nom 2-1/4 in. (57 mm) wide by nom 0.05 in. (1.25 mm) thick intumescent gasket installed within the bottom joint, flush with the top surface of the bottom slab.

SPECIFIED TECHNOLOGIES INC - Speed Flex Track Top Gasket

- D. Joint Compound** - Nom 1/4 in. (6 mm) thickness of joint compound installed within the bottom joint, flush within the bottom surface of the bottom slab. Additional joint compound to be applied over fiberglass mesh tape on the bottom surface of the bottom slab to overlap onto the slabs on both sides of the joint a min of 2 in. (51 mm).

* Indicates such products shall bear the UL or cUL Certification Mark for jurisdictions employing the UL or cUL Certification (such as Canada), respectively.



Specified Technologies Inc. 210 Evans Way Somerville, NJ 08876

Reproduced courtesy of Underwriters Laboratories, Inc.

Created or Revised: January 18, 2019

(800)992-1180 • (908)526-8000 • FAX (908)231-8415 • E-Mail:techserv@stifirestop.com • Website:www.stifirestop.com

